

**INSTALLATION INSTRUCTIONS FOR LAUNDRY TUB FAUCET
INSTRUCTIONS D'INSTALLATION POUR ROBINET DE BUANDERIE**

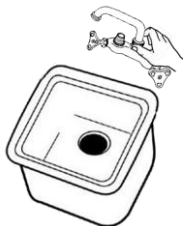

**Shut off water supply. Remove your old faucet.
Coupez l'approvisionnement en eau. Enlevez votre vieux robinet.**

**If laundry tub has no ledge:
Si cuve n'a pas un rebord**

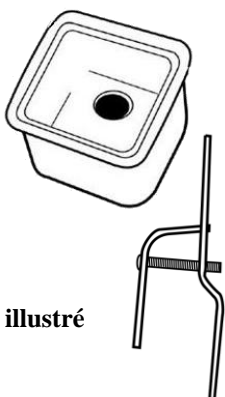

**Use both brackets as shown.
Utilisez les deux supports que illustré**

**Attach brackets to tub, as shown.
Use bolt provided
Fixez les supports de la cuve que illustré
Utilisez boulon donnée**



**If laundry tub has a ledge:
Si cuve a un rebord**

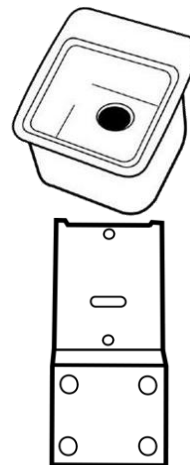

**Use this bracket only.
Utilisez ce support seulement**

**Attach bracket to tub as shown
May require drill and 4 bolts to attach.
Fixez le support de la cuve que illustré
Peut nécessiter une perceuse et 4 boulons pour attacher**

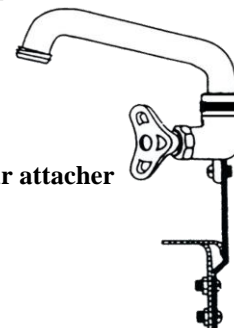

**Attach faucet to bracket with bolt provided
Attacher robinet à support avec la vis de donnée**

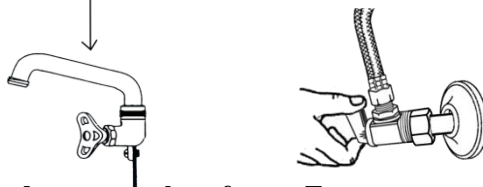
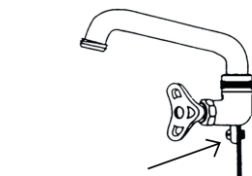

**Attach spout and water supply to faucet. Turn on water and check for leaks
Attacher le bec et l'approvisionnement en eau
Activez l'eau et vérifier pour fuites avant d'utiliser**



**PLUMBERS SPECIALTY
SUPPLY PLUS**

1201 FRANKLIN BLVD. CAMBRIDGE, ON CANADA N1R 6R7